

# Blood Lead Testing: Sending Specimens to the State Lab

**150 µL is the minimum that can be tested. Seal the tube well.**

**Put 2 unique identifiers on the specimen tube's label.**

For example Patient's First and Last Name AND Date of Birth.

*Information on the specimen and DHHS 3707 form must match EXACTLY.  
If the specimen label has John, the form cannot have Johnny, Johnathan, etc.*

**Complete the entire DHHS 3707 form for each specimen.**

Available at: <https://slph.dph.ncdhhs.gov/Forms/3707-Blood-Lead-Analysis.pdf>

*DO NOT alter the form.*

*Use the most current version.*

*Ensure all information is accurate. Inaccurate submissions are subject to rejection.*

*For Medicaid patients, enter Medicaid # (required) and Member ID # (if applicable).*

**Seal tube with absorbent material in a leak-proof specimen bag.**  
**Slide folded DHHS 3707 form in outer sleeve of bag.**

Use enough absorbent material to soak up all liquid in case of leaks.  
One specimen per bag.

**Package specimens as UN3373 Biological Substance, Category B.**

The State Lab boxes can transport up to 50 mL of blood, per shipping regulations.  
Use a State Lab Blood Lead label if supplying own box.

*Envelopes are not acceptable.*

*Attach a return address label, including responsible person with phone number.*

*Add cushioning to protect specimen(s) in transit.*

**Ship at ambient temperature.**

**Need supplies or help?**

Call SLPH Customer Service at 919-733-3937,  
SLPH Mailroom at 919-733-7656, or visit us at  
<https://slph.dph.ncdhhs.gov/hemachem/resources.asp>

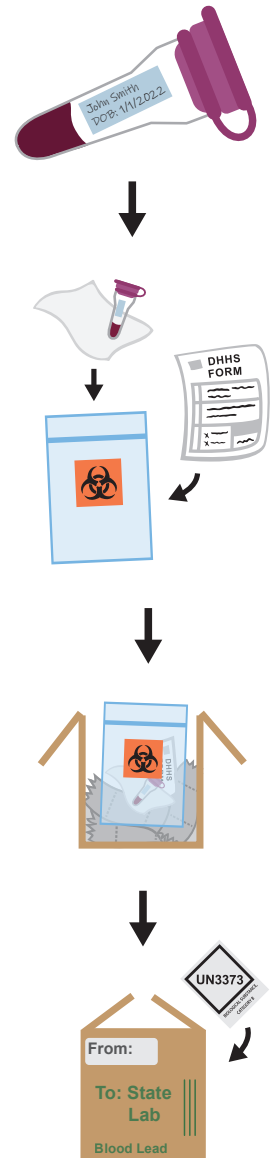

NC Department of Health and Human Services  
Division of Public Health  
North Carolina State Laboratory of Public Health  
<http://slph.dph.ncdhhs.gov> 5/31/2022 NCDHHS  
is an equal opportunity employer and provider.